

GN 433

Stainless Steel-Wing screws

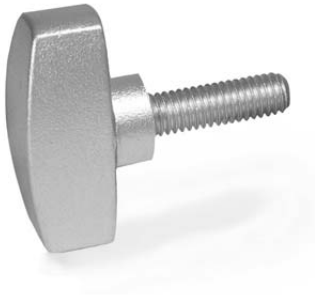

Specification

Stainless Steel AISI CF-8 (Precision casting)
matt shot-blasted **MT**

Technical information

- [Stainless Steel characteristics](#)

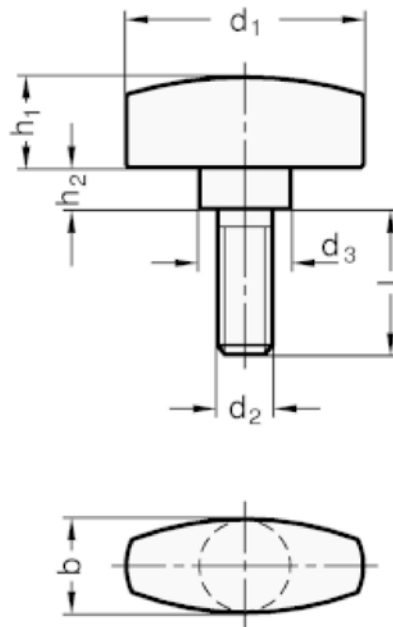

GN 433

Description	d ₁	d ₂	l	d ₃	b	h ₁	h ₂	Weight
GN 433-26-M5-10-MT	26	M 5	10	10	11	10	4.5	25
GN 433-26-M5-16-MT	26	M 5	16	10	11	10	4.5	23
GN 433-26-M6-16-MT	26	M 6	16	10	11	10	4.5	24
GN 433-26-M6-20-MT	26	M 6	20	10	11	10	4.5	24
GN 433-26-M6-25-MT	26	M 6	25	10	11	10	4.5	25
GN 433-34-M6-20-MT	34	M 6	20	12	13	12	5	41
GN 433-34-M6-25-MT	34	M 6	25	12	13	12	5	42
GN 433-34-M6-30-MT	34	M 6	30	12	13	12	5	44
GN 433-34-M8-16-MT	34	M 8	16	12	13	12	5	42
GN 433-34-M8-20-MT	34	M 8	20	12	13	12	5	43
GN 433-34-M8-30-MT	34	M 8	30	12	13	12	5	48